

Section 10 Consultation

Proposed opening of Watling Meadows Primary School

Proposal: Open a new Primary Free School at Callendar Farm, Nuneaton

Proposed Opening: September 2026

Proposer: Central England Academy Trust

Table of Contents

- »» Introduction
- »» The Proposal
- »» Vision & Values
- »» Context & Rationale
- »» Admissions & Catchment
- »» Site & Facilities
- »» Education Offer
- »» Staffing & Leadership
- »» Impacts & Consideration
- »» Consultation Process
- »» Frequently asked Questions
- »» Provisional Images

Introduction

Central England Academy Trust is delighted to launch this consultation under Section 10 of the Academies Act 2010. The Trust are proposing to open a brand new two-form entry (2FE) primary free school – Watling Meadows Primary School - to serve the growing community at the Callendar Farm development, Nuneaton, with a planned opening of September 2026. The consultation aims to seek opinions on whether the Secretary of State and Central England Academy Trust should enter into a funding agreement for the school.

As part of this consultation process, CEAT are keen to seek the views and opinions of all stakeholders. Stakeholders include but are not limited to parents/ carers, local residents, businesses, local primary and secondary schools, community and faith groups, health centres, day care providers, leisure facilities and housing associations.

The Proposal

- School Name: Watling Meadow Primary School
- School type: Primary Free School
- Location: Callendar Farm development, Nuneaton. Approximate postcode CV11 7AD
- Opening date: September 2026
- Age range: Reception (4 years) to Year 6 (11 years)
- Capacity: Up to 420 pupils at full capacity (60 pupils per year group)
- Specialist Resource Provision: up to 14 places to support communication and interaction needs
- Phased opening: Initially opening in September 2026 with 30 Reception pupils, growing year on year to achieve full capacity
- Proposer: Central England Academy Trust, an experienced multi-academy trust with a strong track record of running successful schools in Nuneaton.

More information about our Trust can be found on our website: www.centralengland.co.uk

Vision & Values

Central England Academy Trust (CEAT) is a Multi-Academy Trust (MAT) based primarily in the Nuneaton area of Warwickshire. We are a diverse Trust currently consisting of five schools: Oak Wood Primary Special School, Oak Wood Secondary Special School, Higham Lane Secondary School, Michael Drayton Junior School and Higham Lane North Academy. All of our schools are Ofsted rated as 'good' or 'outstanding' and we have a secure and solid foundation on which to build and grow the proposed school. We are an inclusive and child-centred Trust, and every decision that we make is always done in the best interests of the young people entrusted to our care.

Our family of schools all serve their local communities and are built on our core CEAT values:

Collaboration (Better together): To work closely and productively with others for the greater good of everyone involved. To be positive, thoughtful and supportive towards others through showing appreciation and respect of own and other cultures, values and beliefs. We want everyone in our Trust to feel as though they are an important part of a large family.

Equity (Fairness): Recognising that we do not start from the same place. Equity is about providing others with what they need in order to provide equal access to opportunities. We want our school communities to be happy, empowered and supported through democratic processes and robust systems and structures where the autonomy, strengths and uniqueness of the individual is supported, promoted and celebrated.

Aspiration (Be your best self): To always be ambitious ensuring that pupils and staff in our schools have the knowledge and skills to progress towards their aspirations and beyond. To support pupils to take their place in society and achieve success in adulthood.

Trust (Feeling safe): To feel safe knowing that the reactions of others are well meaning and that systems and structures to support are consistent and predictable. To be well-informed and kept up-to-date and empowered to communicate wishes, concerns and opinions without fear of retribution.

We aim to continue building our family of like-minded schools who share our passion for inclusive and aspirational learning in our area. We work closely with our families, local community services and Warwickshire County Council to make sure that the pupils we serve get the very best provision and support.

We are proud of our inclusive ethos, and specialise in supporting our own and other Warwickshire schools with their approach. We run a high profile and highly effective 'outreach' programme on behalf of the Virtual School to support disadvantaged children and those who are looked after, as well as providing system leadership support to Warwickshire. We also have a SEND specialism and work closely with Warwickshire on strategy and provision in this key area.

CEAT exists to serve and advocate for the children and families in our communities, and we are dedicated to ensuring that they have the very best life chances and opportunities. We intend to instil these values within our pupils from the opening of the school and beyond. This will ensure that the proposed school becomes truly integrated into the Trust ethos, as well as its local community.



Context & Rationale

Nuneaton has experienced significant population growth in recent years, particularly due to large-scale housing developments such as Callendar Farm. This development is part of the larger 4,419 home urban extension that is currently building out to the North of Nuneaton. The school will be required to provide education to pupils moving into the area as a result of this housing development. Warwickshire County Council's school place planning/ sufficiency projections show a growing demand for primary school places in this area.

The proposed new school will help ensure that every child has access to high-quality local education close to home, preventing oversubscription pressures on existing schools and reducing travel distances for families.

This is the second of three primary schools proposed to meet the need for school places as a result of the large-scale housing development in the area. The first new primary school, Lower Farm Academy, opened in September 2019 and has been expanded to accommodate 2FE entry. The third new primary school, on the Top Farm development, is likely to be beyond the 5-year forecast period.

Nuneaton North East Planning Area				
Year	Reception Capacity	Reception Forecast Pupil Numbers	Available Capacity (N)	Available Capacity (%)
2025	270	280	-10	-4%
2026	240	267	-27	-11%
2027	240	258	-18	-8%
2028	240	259	-19	-8%
2029	240	273	-33	-14%

Within a 2 mile radius of the proposed school site (Callendar Farm Development), there are currently:

- 2 Secondary Schools - Higham Lane School and Higham Lane North Academy (both part of Central England Academy Trust)
- 2 Primary Schools - St Nicolas CofE Academy and Milby Primary School.

The proposed school will include a Specialist Resource Provision (SRP) for 8-14 pupils with Communication and Interaction needs. Warwickshire SEND and Inclusion Strategy advocates for the provision of specialist placements within the mainstream provision. CEAT currently runs a Specialist Resource Provision for Secondary aged pupils at Higham Lane North Academy. The Trust has a specialism in SEND and runs two special schools in Nuneaton (Oak Wood Primary and Oak Wood Secondary). Staff from across the Trust benefit from shared training and support networks to ensure high quality provision that enables all pupils to thrive.

Admissions & Catchment

The school will adopt fair and transparent admissions arrangements, in line with the School Admissions Code.

The school has an admission number of 30 for Reception in September 2026. It will admit this number of pupils if there are sufficient applications. If fewer than 30 applications are received, all applicants will be offered a place. The academy trust will admit any pupil with an Education, Health and Care plan which names the school.

Priority will then be given to children who meet the criteria set out below, in order.

- 1. Looked after children and previously looked after children.
- 2. Children who are currently, or have been at any point since 1st September 2025, subject to a Child in Need Plan or a Child Protection Plan, with no more than 9% of the places available to be allocated under this category
- 3. Children who live in the school's catchment area (priority area), in the order set out below:
 - a. Siblings of pupils attending the school at the time the application is received.
 - b. Other children living in the priority area.

Children living on the boundary line will be considered to live in the priority area. The priority area is shown in the map at the end of this policy and described there.

- 4. Children living outside the priority area who will have a brother or sister at the school at the time of admission.
- 5. Children of any staff living outside of the priority area and who have been employed for two or more years at the school at the time the application is received, and/or those recruited to meet a demonstrable skills shortage.
- 6. Other children living outside the priority area.

CEAT have included a proposed Admissions policy – please see website for more information. <https://centralengland.co.uk/new-primary-school/> Admissions will be coordinated via Warwickshire County Council's admissions process. Parents/carers should apply directly to Warwickshire County Council, and the Academy adopts Warwickshire County Council's In-Year Fair Access Protocol. Applicants living outside of Warwickshire should apply through their local authority's admissions process.

Site & Facilities

The school will be delivered as part of the Callendar Farm development. The project is funded and delivered by Warwickshire County Council. Central England Academy Trust participated and were successful in a bid to open the school as part of the presumption free school route.

Proposed facilities include:

- Modern, purpose-built classrooms
- A multi-purpose hall for sport, performance, and dining
- Outdoor play and learning areas including specialist nature areas
- Green space and sports facilities for physical education and wellbeing
- SEND specialist resource provision offering 8-14 places for pupils with Communication and Interaction needs

Plans are available to view on our website <https://centralengland.co.uk/new-primary-school/>

Education Offer

Our vision is to provide inclusive, high-quality education that prepares children for lifelong learning and active citizenship.

Education Plan

We are privileged to be able to make a difference to the lives of our children and the choices they make about their future. All children at our primary school will receive a broad and balanced curriculum offer, alongside high quality of teaching and learning and delivery. It will be underpinned by key principles that will permeate through all aspects of our curriculum. These will include:

- Foundation of basic skills, including phonics and reading, oracy and mathematics
- High aspirations, exposing children to a variety of curriculum content and opportunities, which in turn will raise aspirations in our school
- Ensuring equity for all children, making sure we provide the experiences (cultural capital) and support needed for all to thrive and achieve their full potential
- Focus on our locality, adapting curriculum plans to our local area and context

These drivers form the foundation of our 'Ex factor' curriculum:

'Ex Factor' Curriculum Drivers - Summary				
Excite	Experience	Expertise	Extend	Excel
Inspired and enthusiastic to learn through engaging sequences of lessons, each of which builds on prior knowledge, promoting high aspirations	High quality experiential opportunities and support that develop children's cultural capital and further build and embed their schemas, ensuring equity for all	focus on teaching the basic skills such as phonics, reading, oracy and maths, ensuring children become 'experts'	Build on prior knowledge. Focus on core knowledge. Revisit and embed in long term memory with quizzes, books etc.	Understand what is needed and produce high quality pieces of work in order to feel successful and proud and achieve to their full potential.

Our curriculum will be based on the national curriculum, offering its full breadth and ambition to all pupils.

In addition to this, our curriculum will be further enhanced with a focus for all pupils in the following areas which will spiral through every subject and across school:

- Communication strategies and environment, e.g. Makaton, communication in print, visual representations etc.
- SMSC which will be mapped out and embedded across the curriculum, as well as being promoted daily through our inclusive ethos.
- A focus on our locality and context, for example studying the Battle of Bosworth in history, to make things relevant and real for the children, and focussing on industries and opportunities in our area, e.g. engineering / technology.
- Outdoor learning opportunities, including Forest School and environmental learning
- Safeguarding curriculum including PREVENT, E-Safety, protective behaviours, anti-racism etc
- Social responsibility – Rights Respecting Schools, protecting and restoring our environment, human rights, homelessness, refugees, fair trade, engaging with local charities.

EYFS Provision

In the Early Years Foundation Stage at our primary school, our children develop physically, socially, verbally, cognitively and emotionally in an inclusive environment which values all cultures, communities and people. We strive for our children to grow into confident, independent learners and well-rounded young people able to achieve to their full potential.

Our Early Years provision is designed to:

- Reflect the four overarching principles outlined in the Early Years Statutory Framework: The Unique Child, Enabling Environments, Positive Relationships, Learning and Development
- Strengthen and build upon prior learning and life experiences, ensuring children make good progress over time
- Be flexible, allowing the children's interests and needs to be reflected throughout our provision
- Enrich children's vocabulary and develop their oracy skills
- Enable children to discover, explore, make decisions and express their own ideas
- Prepare children for the next stage in their learning journey

Proposed timings of the school day (EYFS, KS2 and KS2)

Breakfast club

Registration: 8.45am

Morning break: 10.45am – 10.55am (staggered by key stage as the school grows)

Lunchtime: 12.30pm – 1.30pm (staggered by key stage as the school grows)

End of day: 3.15pm

Afterschool clubs

Wraparound care

An extended school day will be available for those families who require it to provide wrap around care for pupils, although time that extends beyond legal statutory provision will be run as an income generation stream for the school.

Meeting the needs of all learners

Our curriculum offer will have a key focus on helping pupils to ‘catch up and keep up’ with learning across the curriculum, but in particular in English and Maths. Lesson content will be adapted and scaffolded for pupils, and same day support / intervention will be in place to ensure that it has been understood and learned (‘keep up’ element). For pupils who are not working at the expected level and need support to ‘catch up’, research-based interventions (small group or 1-1) will be planned for and put in place.

Inclusive provision is at the heart of our Trust and we want to maximise the benefits of our specialism to support all pupils in the new mainstream primary school. We believe that all pupils should receive the support and adaptations they need to attain their full potential, in a supportive and nurturing environment. Inclusion requires early identification of barriers to learning and success, followed by creative thinking to ensure a solutions-focused approach to strategies and interventions.

We will ensure that our primary school has a positive and inclusive approach to meeting the needs of all of our pupils. This includes creating a safe, nurturing and trauma informed environment where everyone feels safe, included and that they belong. The establishment of a specialist resource provision as an integral part of our schools will further enhance our provision and expertise in supporting pupils.

Transition

We will draw on the wealth of expertise, skills and resources available in our Trust and provide carefully managed, tailored transition support for all pupils both at entry to the school in Reception when they leave in Year 6 for secondary school.

We will work closely with parents and local nursery settings, ensuring that pupils are familiar with the staff and setting before starting, and that are aware of pupils’ needs and have the right support and provision in place for them. This will involve visits to settings and conversations with key workers, parent meetings and transition events for pupils to attend so that we can build up profiles.

Staffing & Leadership

The school will be led by a Headteacher appointed in advance of opening, supported by an experienced leadership team. Staff recruitment will focus on the benefits of being a founding member of staff at the new school to ensure high-quality teaching, pastoral care, and support for all pupils. Specialist qualified staff will be recruited to deliver high quality SEND provision.

Central England Academy Trust's (CEAT) Central team are based in Nuneaton and committed to providing additional capacity during the opening year and beyond. CEAT have mapped out a staffing structure that will expand with the school as pupil numbers increase, year on year. CEAT's family of schools are all based within a short distance from the proposed site which allows for easy access to training, support and sharing of resources.

Central England Academy Trust will provide governance oversight, professional development opportunities, and strong financial and operational management.

Impacts & Considerations

We expect the school to have a positive impact by:

- Meeting demand for primary school places from new housing developments
- Reducing pressure on existing local schools
- Providing families with a high-quality, local school within walking distance
- Supporting community cohesion within the new development
- Enhancing extra-curricular opportunities and potential use of facilities for community use
- Provide enhanced transition arrangements for pupils transitioning to one of our secondary schools within the Trust (Higham Lane School and Higham Lane North Academy)
- Trust support network includes 2 special schools and a specialist resource provision at HLNA.

Environmental considerations, traffic management, and safe access have been factored into the final site design and planning process. The Trust and school will actively promote pupils walking, cycling or scooting to school.

Contingency plans have been carefully considered and are in place should unforeseeable building delays arise, these include partial opening of the school site and interim alternative accommodation.

Consultation Process

This consultation is a statutory consultation under the Section 10 of the Academies Act.
It runs for 6 weeks from: 9 am on Friday 3rd October 2025 – 9am on Friday 14th November 2025

How you can respond:

- Complete our online survey: <https://www.surveymonkey.com/r/DVG7JW2>
- Attend a consultation meeting (details below):
 - Virtual Consultation Session at 11am-12pm on Monday 20th October 2025 - link provided on request from vmckay@centralengland.co.uk
 - Consultation Drop-In at 4pm-6pm on Thursday 6th November 2025 at Higham Lane North Academy
- Email contact for further details regarding the consultation process to: vmckay@centralengland.co.uk
- Paper copies of the survey are available on request. Please contact Vicky McKay on Tel: 02476740932
- Write to us at: Central England Academy Trust, Morris Drive, Nuneaton, CV11 4QH

Frequently asked Questions

What is a free school?

Free schools are state-funded schools that ran by academies or organisations such as charities as a not-for profit organisation. They are set up by academy trusts and are directly funded by the Department for Education (DfE). Free schools follow the national admissions code, are free to attend, and are inspected by Ofsted in the same way as all other state schools.

Why does Nuneaton need a new primary school?

Significant housing growth at Callendar Farm and nearby developments has created rising demand for local school places. Warwickshire County Council's planning/sufficiency data shows that existing schools will not have capacity to meet the increasing demand. This new free school will ensure that children living in the area have access to high quality education within their community.

Who is behind this proposal?

The proposed school will be opened via the free school presumption route and will be delivered and funded by Warwickshire County Council. Central England Academy Trust was successful in its bid to lead and manage the school alongside its current highly successful schools in Nuneaton. Central England Academy Trust is an experienced multi-academy trust with a proven track record. The Trust currently comprises of Higham Lane school, Higham Lane North Academy, Michael Drayton Junior School, Oak Wood Primary and Oak Wood Secondary. The Trust will be responsible for appointing a Headteacher Designate, governance, financial planning, and educational standards of the new school. Warwickshire County Council and Central England Academy Trust are working in partnership to ensure that the project is delivered in a timely manner and to a high standard.

Frequently asked Questions (continued)

Where will the school be located?

The proposed school will be built on land secured as part of the Callendar Farm housing development, to the East of the urban extension that is currently building out to the North of Nuneaton. Located at Watling Street, St Nicholas Park, Nuneaton & Bedworth, Warwickshire. Approximate postcode CV11 7AD. The site sits within the Nuneaton North East Primary Planning Area, close to the Warwickshire boundary with Leicestershire.

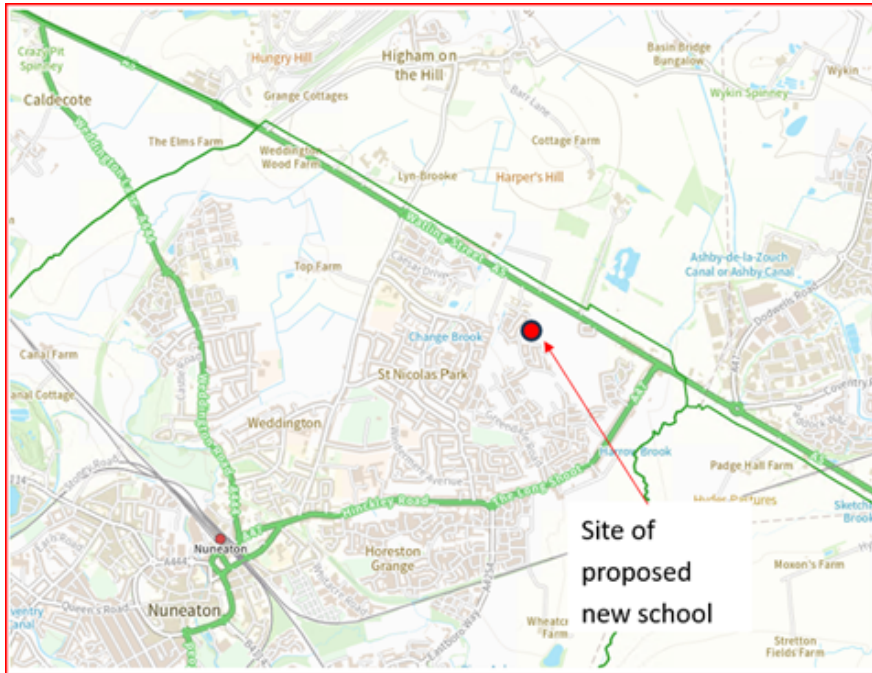

When will the school open?

The school is proposed to open in September 2026, starting with places in Reception. The school will grow year on year until it reaches full capacity.

How many children will the school take?

The school will be a two-form entry primary school, admitting 60 pupils per year group. The initial cohort in September 2026 is planned to accommodate 30 Reception pupils and the pupil numbers will increase gradually. The school will cater for 420 pupils once at maximum capacity.

Will other year groups be opening in September 2026?

The school will be growing year on year from Reception. The opening of other year groups will be subject to sufficiency requirements and discussion with the LA.

How will admissions work?

The Admissions policy can be seen on the CEAT website <https://centralengland.co.uk/new-primary-school/>. Admissions will be coordinated via Warwickshire County Council's admissions process.

Frequently asked Questions (continued)

Will the school provide for children with special educational needs and disabilities (SEND)?

The school will be fully inclusive, with specialist staff and facilities to support children with SEND. We are committed to ensuring all children receive the support they need to thrive. The school will include a SEND resource provision (SRP) of 8-14 places catering for communication and interaction needs. The SRP will have its own dedicated area within the school. Pupils attending will need to have an EHCP, and go through WCC's High Needs Provision Panel. WCC will work in partnership with the school to set up the provision and support with recruitment and ongoing development of the provision. SRP model supports integration into mainstream classes. Pupil numbers for the SRP will be in addition to mainstream PAN.

What curriculum will the school follow?

The school will follow the National Curriculum, enriched with:

- Strong focus on reading, writing, maths, and digital literacy
- Broad and balanced subjects including science, humanities, arts, and PE
- Enrichment opportunities such as music, sport, clubs, and community projects
- Outdoor learning and creative curriculum links to the local environment

Who will run the school day-to-day?

A Headteacher will be appointed well in advance of opening to lead the school, supported by senior leaders, teaching staff, and support staff. The headteacher is responsible for the day to day running of the school. The Headteacher and wider team will receive support from our family of schools within the Trust. Executive Leaders from the Trust will be available to offer support and guidance. The school will have its own Governing board who report directly to the Board of Trustees.

How will the new school affect existing schools in the area?

The new school is being established to meet additional demand created by large scale housing growth, not to compete with or replace existing schools. It will help ensure local schools do not become oversubscribed and that families have sufficient choice.

How can I get involved or share my views?

This consultation runs from: 9 am on Friday 3rd October 2025 – 9am on Friday 14th November 2025. How you can respond:

- Complete our online survey: <https://www.surveymonkey.com/r/DVG7JW2>
- Attend a consultation meeting (details below):
 - Virtual Consultation Session at 11am – 12pm on Monday 20th October 2025 link provided on request from vmckay@centralengland.co.uk
 - Consultation Drop-In at 4-6pm on Thursday 6th November 2025 at Higham Lane North Academy
- Email contact for further details regarding the consultation process to: vmckay@centralengland.co.uk
- Paper copies of the survey are available on request. Please contact Vicky McKay on Tel: 02476740932
- Write to us at: Central England Academy Trust, Morris Drive, Nuneaton, CV11 4QH

Frequently asked Questions (continued)

What happens after the consultation?

All feedback will be carefully considered by Central England Academy Trust and the Board of Trustees. Central England Academy Trust will publish a consultation report summarising responses and how they have been addressed. The Trust Board and Secretary of State will decide if they should enter into a funding agreement to open the school. The report will be published on the Trust website within 30 days of the consultation closing.

Provisional Images



Front of school building:



Provisional Images (continued)

First floor plan:



Ground Floor Plan:



SRP plan:

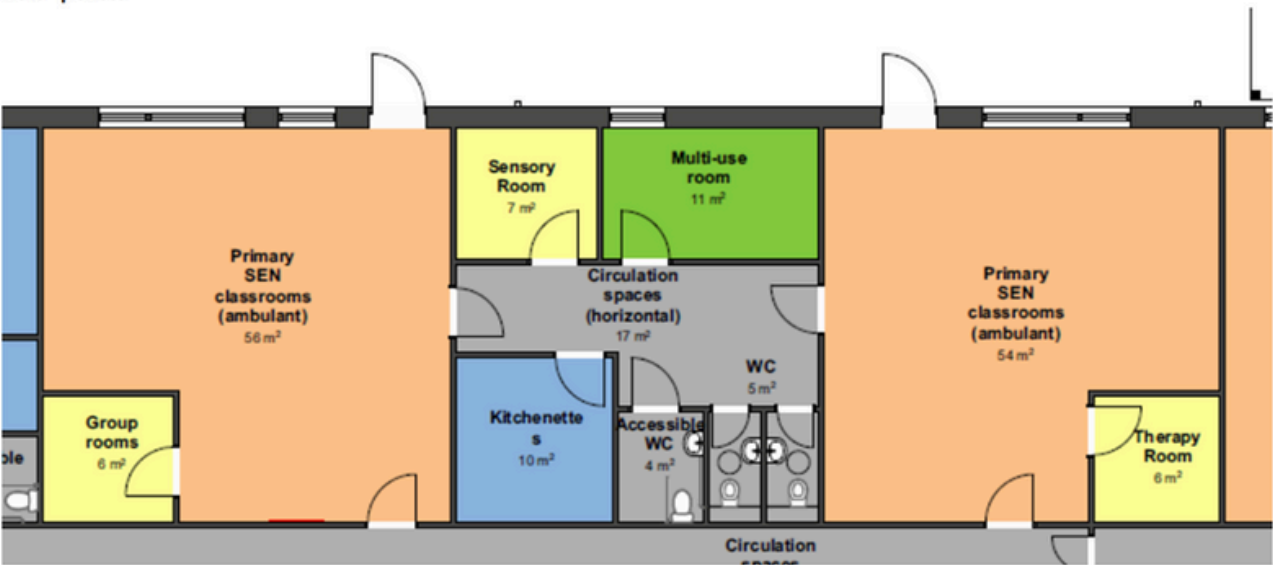

Contact Us



Website

www.centralengland.co.uk



E-mail

admin@centralengland.co.uk



Phone

02476 740932



Address

Central England Academy Trust,
Morris Drive,
Nuneaton,
CV11 4QH